

SPOGLIATOIO 2 (ospitality)

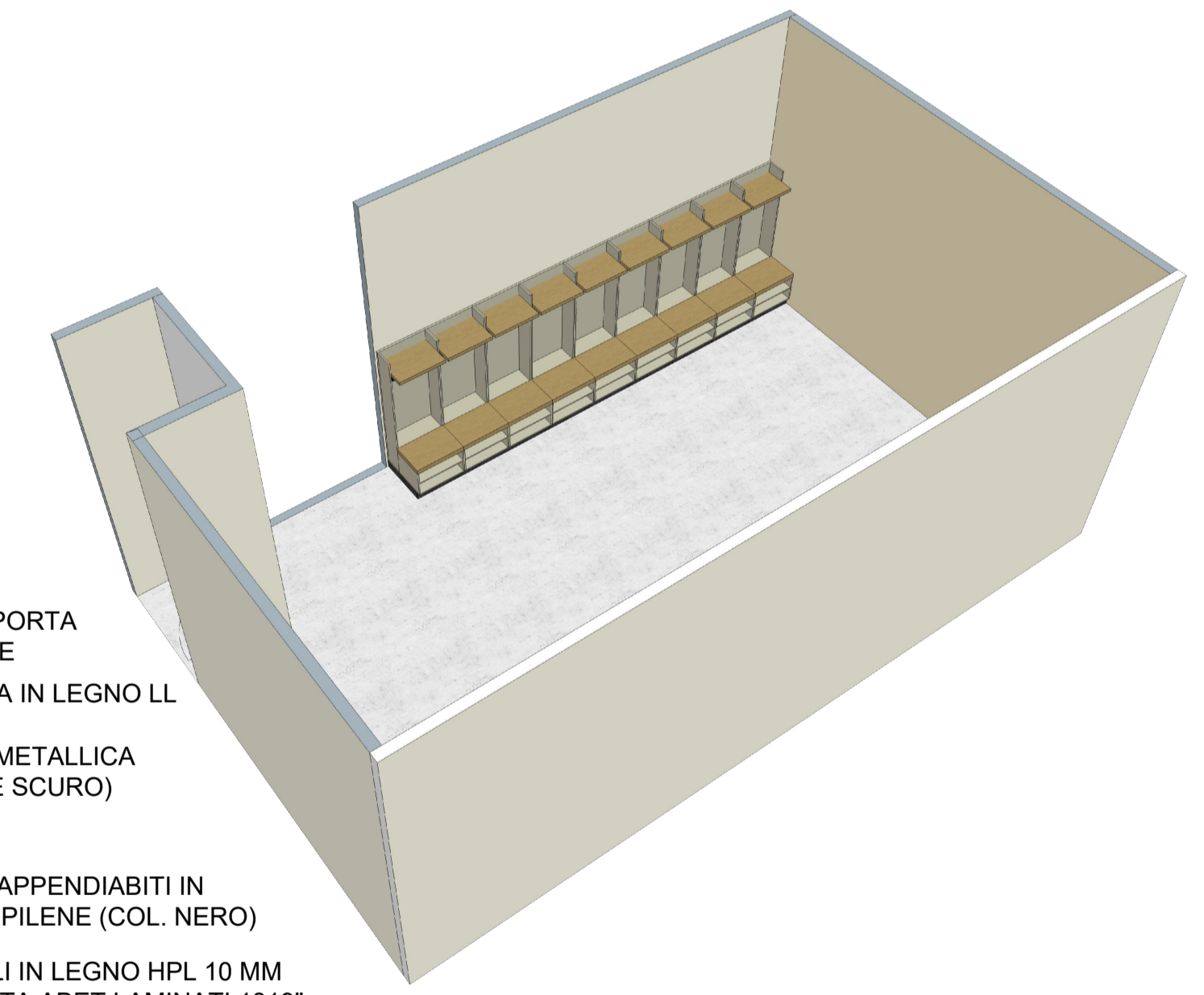
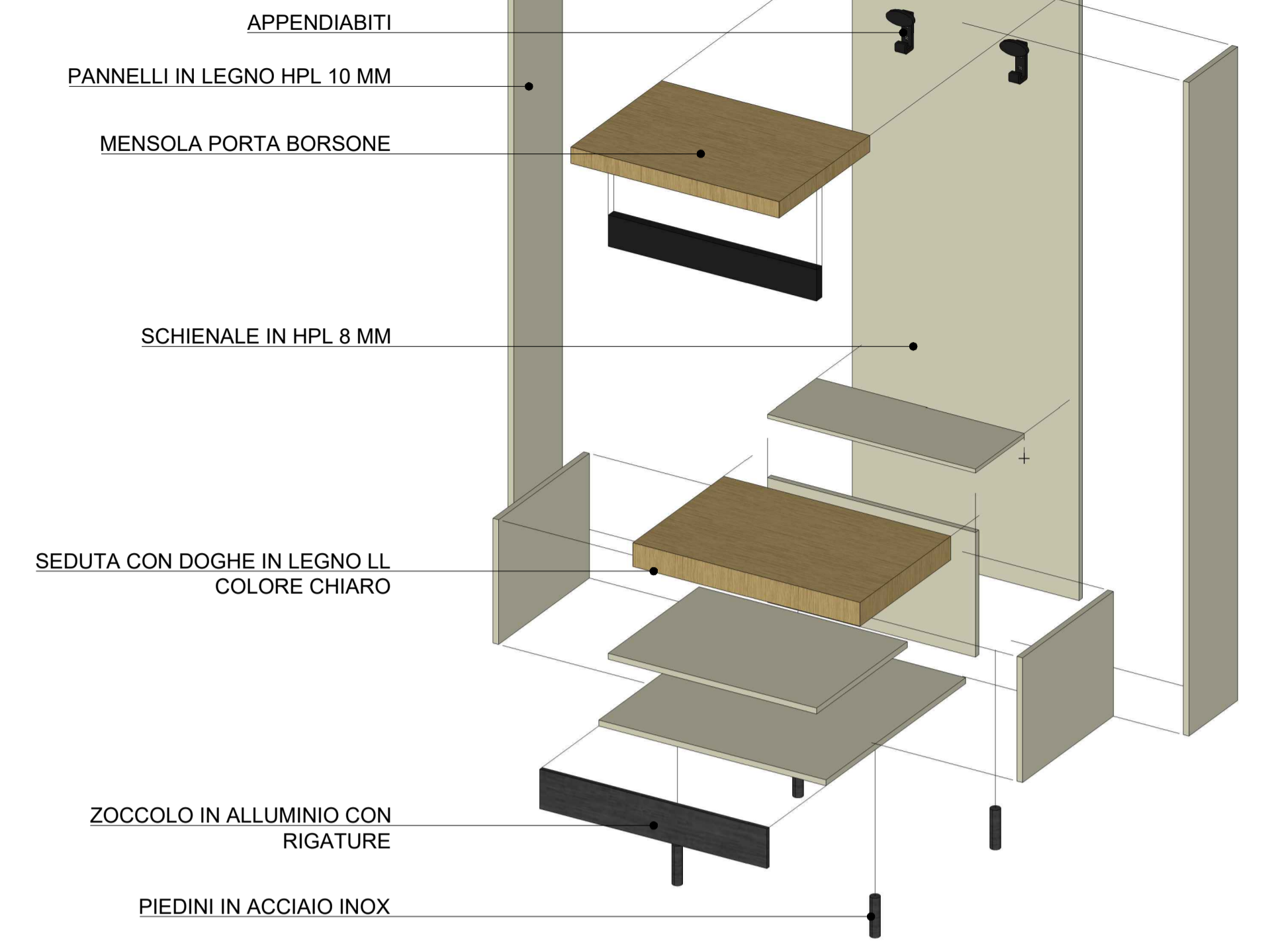
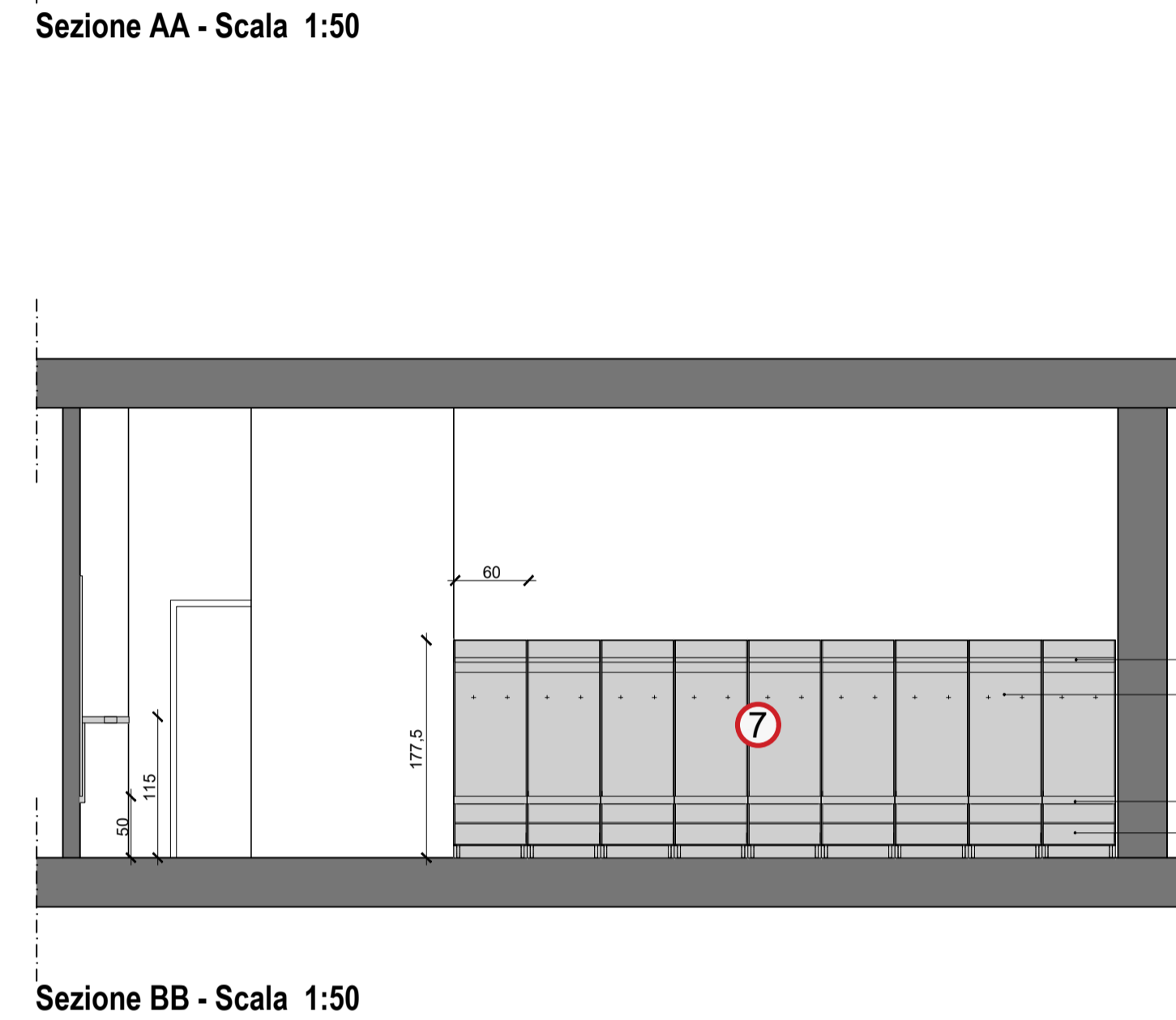
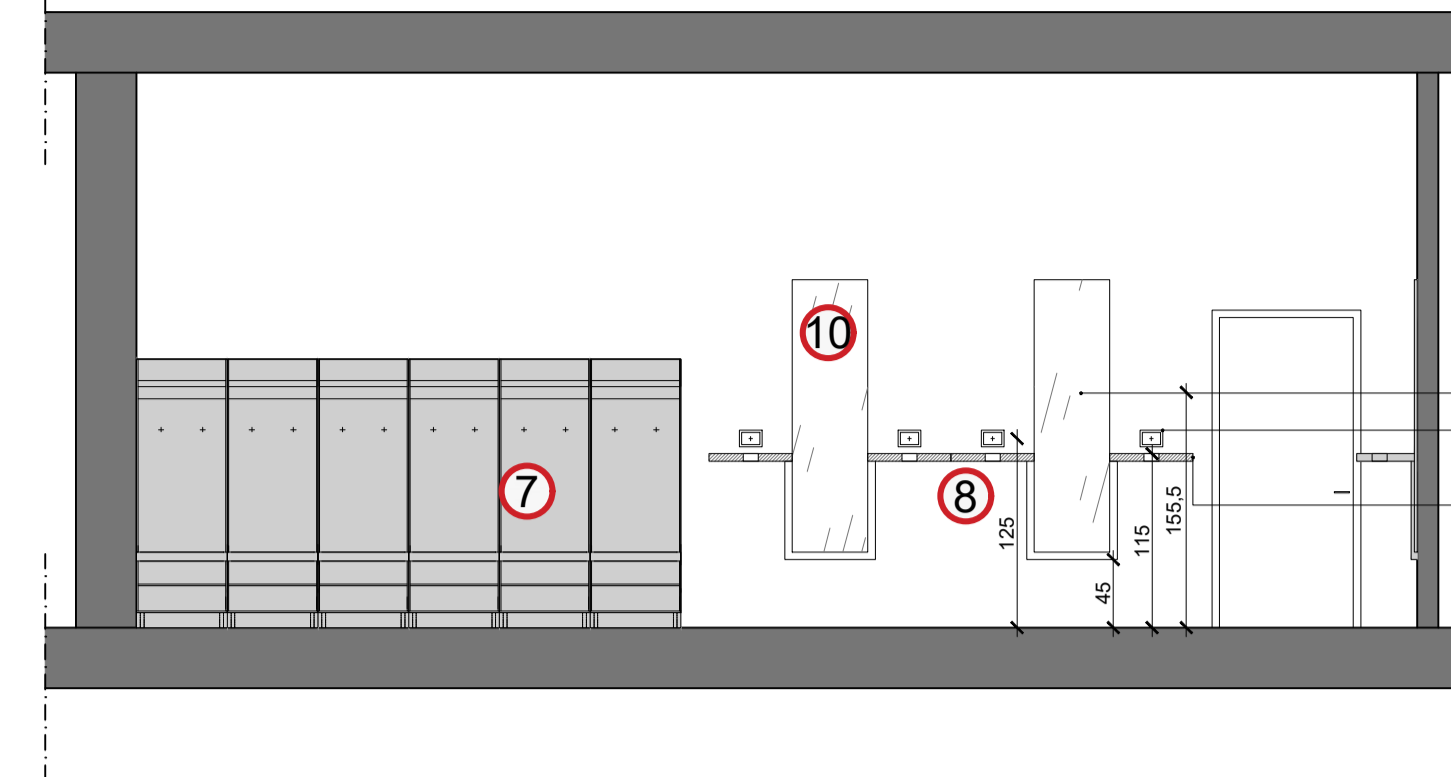
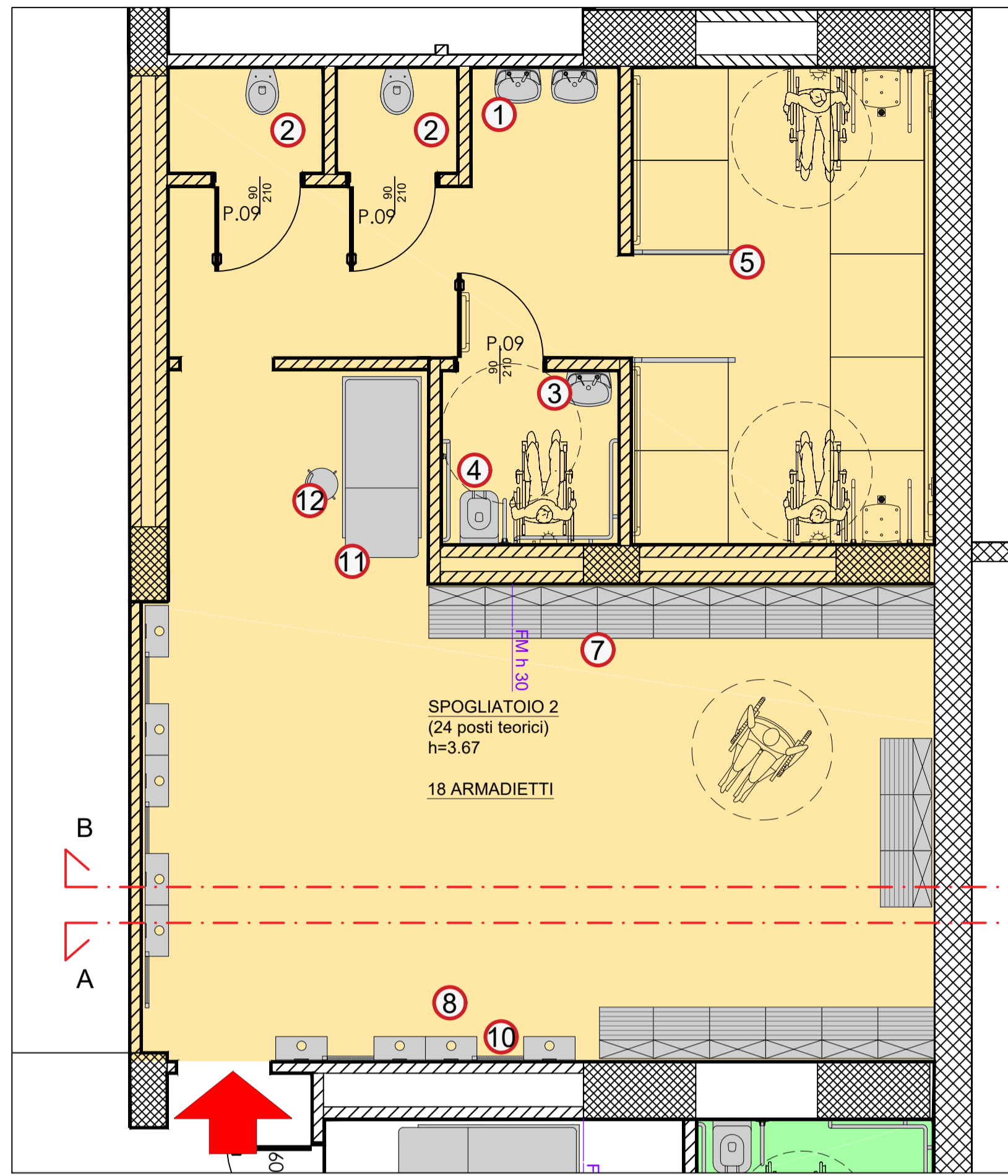

SPOGLIATOIO 2

EQUIPMENT	N°
⑤ separatori docce	2
⑦ armadietti con panca	18
⑧ mensola phon	9 postazioni
⑨ bidone	0
⑩ specchio (50x180 cm)	5
⑪ lettino	1
⑫ sgabello	1

ARREDO BAGNO

① lavabo	2
② wc	2

accessori: specchio, porta sapone, porta carta igienica, scopino

ARREDO BAGNO DISABILI

③ lavabo (H)	1
④ wc (H)	1

accessori: specchio, porta sapone, porta carta igienica, scopino, maniglioni

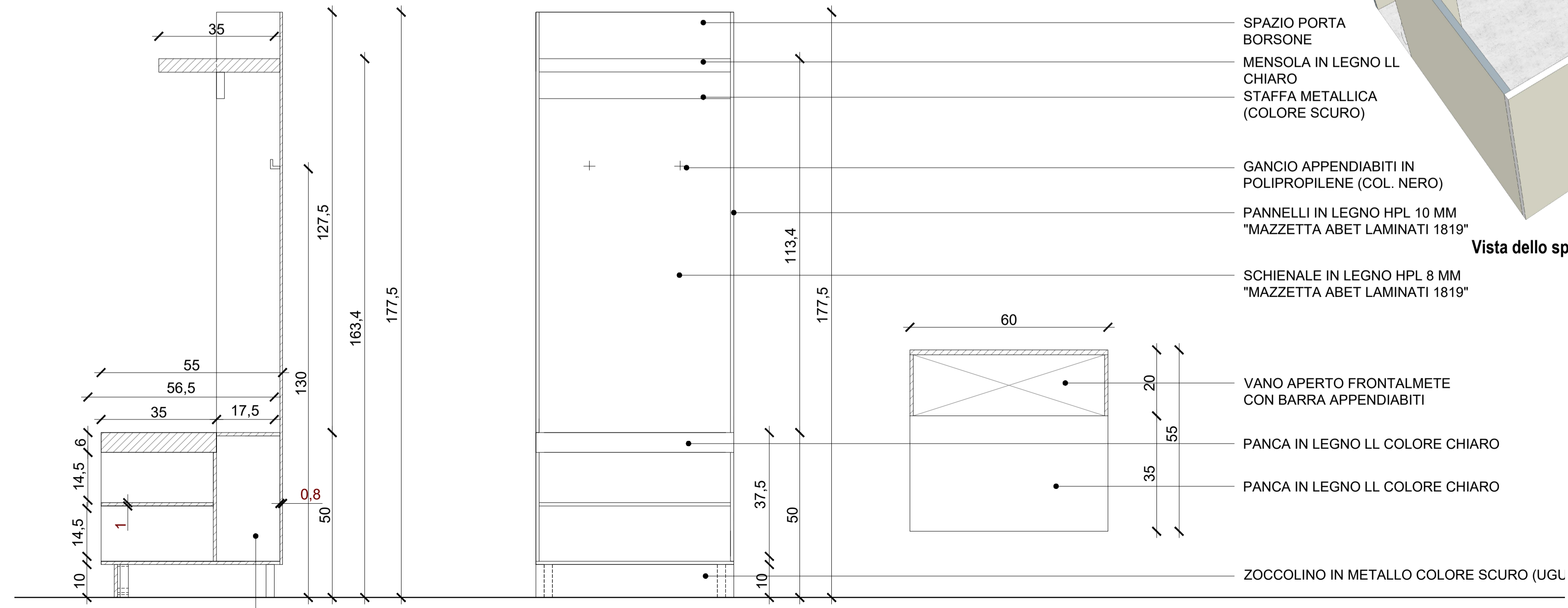

Armadietto spogliatoi - Scala 1:10

VANO CHIUSO